

S:\AFMMachines\44000_Retrofit_Kits_Hot_Stamp_Kensol\44500-Palm_Button_Mount\

ITEM NO.	PART NUMBER	PartNo	DESCRIPTION	QTY.
1	32200_003_14X12_Kensol	-	-	1
2	19050-000	103207	Light Touch Palm Button Bar	1
3	19050-005_2.5_Spacer	105079	SPACER	2
4	44500-001	104832	Palm Buttom Mounting Plate	1

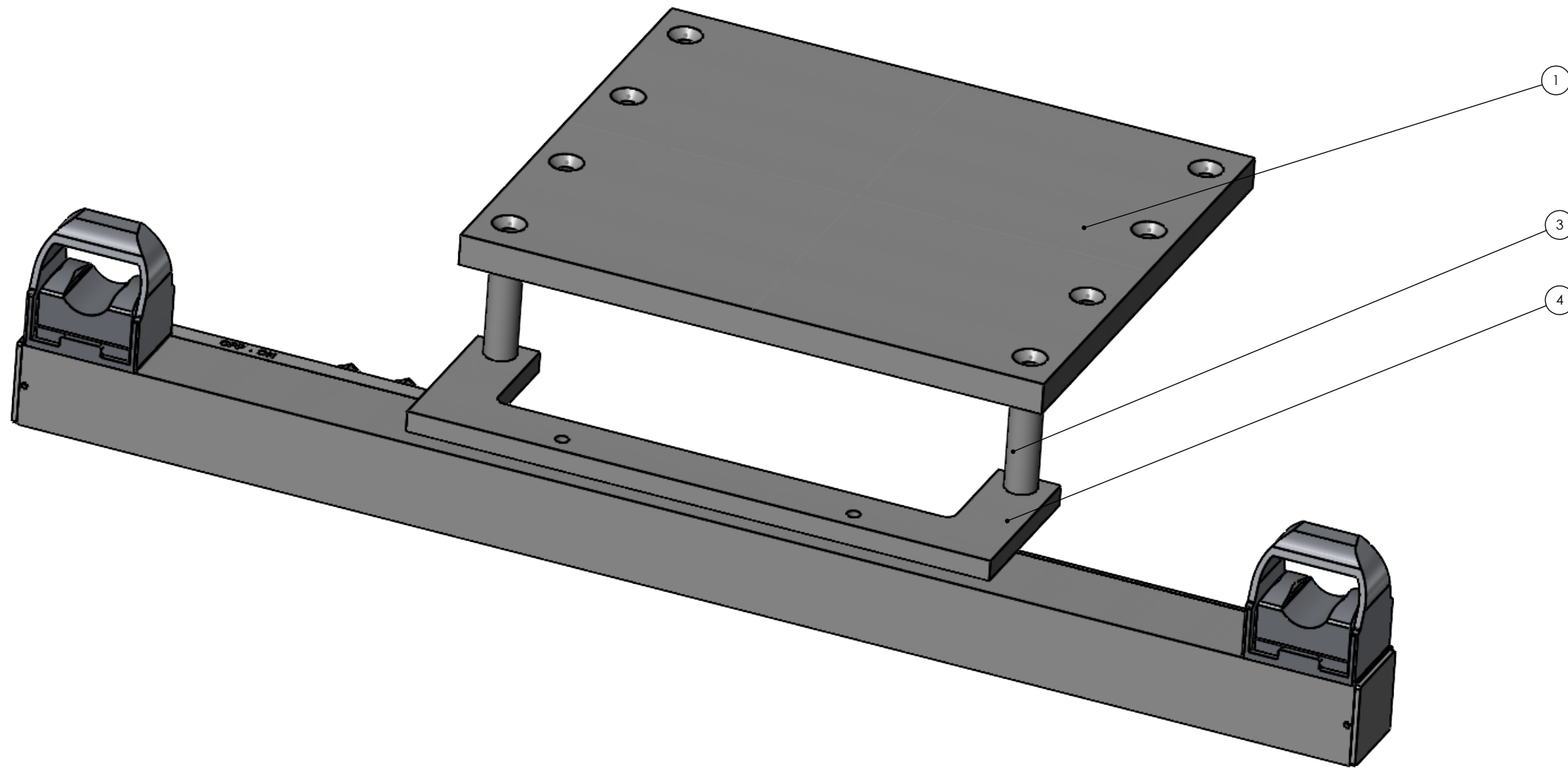

PROPRIETARY AND CONFIDENTIAL
 THE INFORMATION CONTAINED IN THIS DRAWING IS THE SOLE PROPERTY OF AFM ENGINEERING, INC. ANY REPRODUCTION IN PART OR AS A WHOLE WITHOUT THE WRITTEN PERMISSION OF AFM ENGINEERING INC. IS PROHIBITED.

		DIMENSIONS ARE IN INCHES		NAME		DATE		AFM Engineering, Inc.	
		TOLERANCES:		DRAWN		-		AFM Engineering, Inc. Palm Buttom Mounting Kit Kensol 14X12 Table AFM PART # 105080	
		FRACTIONAL ±		CHECKED		-			
		ANGULAR: MACH ± BEND ±		ENG APPR.					
		TWO PLACE DECIMAL ± .010		MFG APPR.					
		THREE PLACE DECIMAL ± .005		Q.A.					
		MATERIAL		COMMENTS:					
NEXT ASSY	USED ON	FINISH							
APPLICATION		DO NOT SCALE DRAWING							
SIZE	DWG. NO.		REV.						
B	000_44500_36T_14X12_								
SCALE: 1:8		WEIGHT: 19.371		SHEET 1 OF 2					

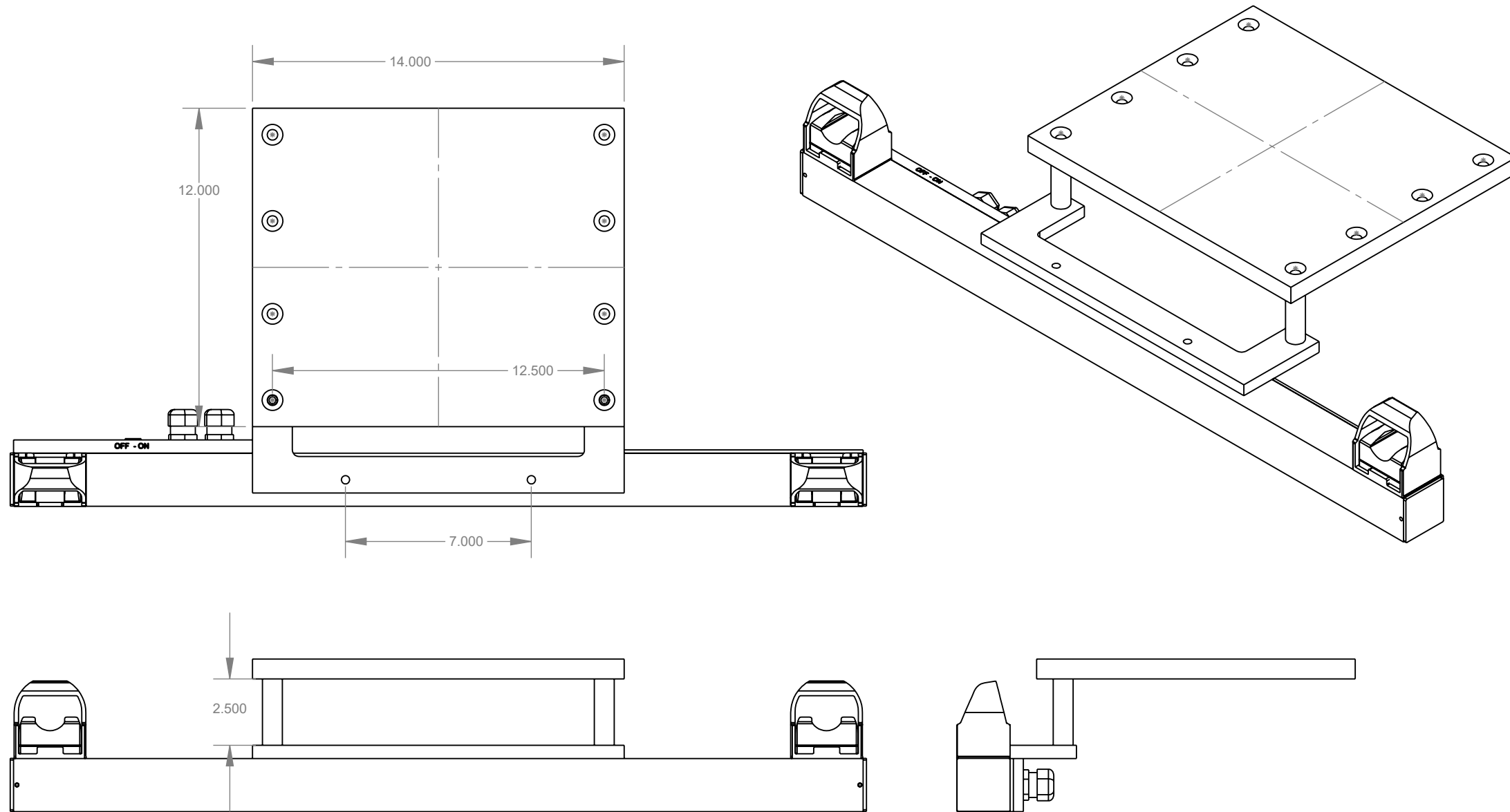

PROPRIETARY AND CONFIDENTIAL
 THE INFORMATION CONTAINED IN THIS DRAWING IS THE SOLE PROPERTY OF AFM ENGINEERING, INC. ANY REPRODUCTION IN PART OR AS A WHOLE WITHOUT THE WRITTEN PERMISSION OF AFM ENGINEERING INC. IS PROHIBITED.

DIMENSIONS ARE IN INCHES		NAME	DATE
TOLERANCES:		IRWIN	-
FRACTIONAL ±		IRWIN	-
ANGULAR: MACH ± BEND ±			
TWO PLACE DECIMAL ± .010			
THREE PLACE DECIMAL ± .005			
MATERIAL			
NEXT ASSY	USED ON	COMMENTS:	
APPLICATION	DO NOT SCALE DRAWING		

AFM Engineering, Inc.		
AFM Engineering, Inc. Palm Button Mounting Kit Kensol 14X12 Table AFM PART # 105080		
SIZE	DWG. NO.	REV.
B	000_44500_36T_14X12_	
SCALE: 1:8	WEIGHT: 19.371	SHEET 2 OF 2